







Access Solutions

# HVAC LOCK



For Air Handling Units

## NEW PRODUCT RANGE

-  **Hassle-free and easy fixing**
-  **Provides secure locking**
-  **Suitable for different door thicknesses**
-  **Complies with IP66 protection standard**
-  **Adjustable grip length**



### MODULAR LOCKING SYSTEM

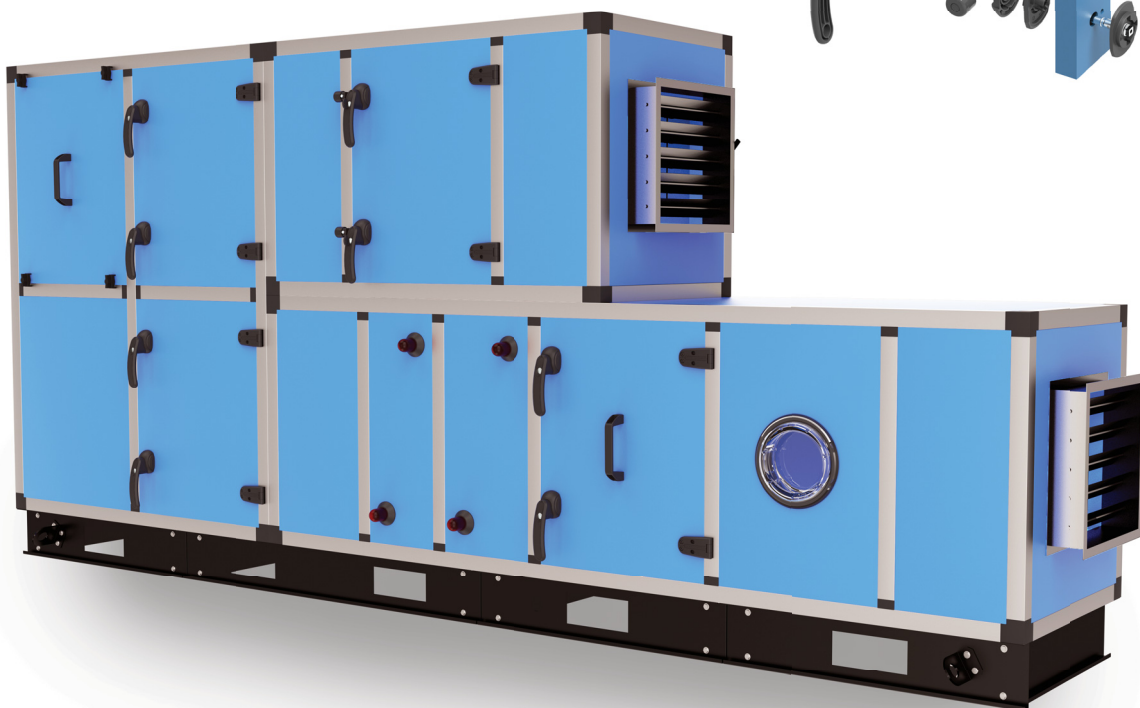



## OUTWARD OPENING DOORS

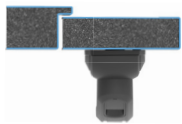

Outside



Cylinder



Without cylinder



Driver



Padlockable



Inside



Fixed cam



Adjustable cam

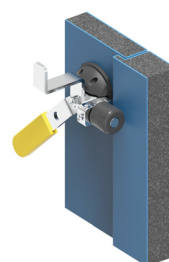

Safety interior handle with safety cam



Safety interior handle



## INWARD OPENING DOORS



Outside



Cylinder



Without cylinder



Driver



Padlockable

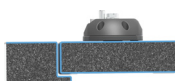

Inside



Standard



Safety interior handle

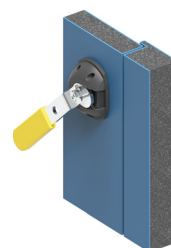

Safety interior handle

## HVAC LOCK



- Ergonomic and stylish design
- Quick fixing
- Secure locking
- Adjustable grip length
- Suitable for outward swing doors

## MATERIAL

**HANDLE:** Polyamide DIN-EN ISO 1043-1 PA6 GFR 30

**CAM:** Steel – PA6 GFR 30

**GASKET:** Polyurethane



Without cylinder



Driver



Padlock application

112

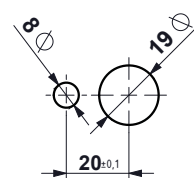
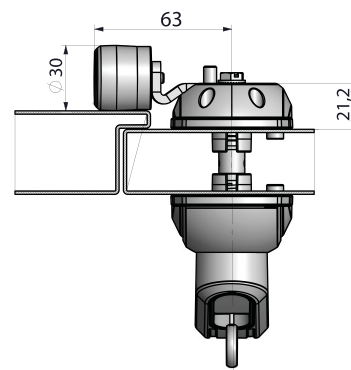
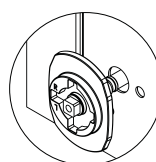
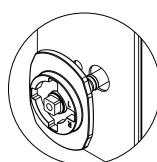
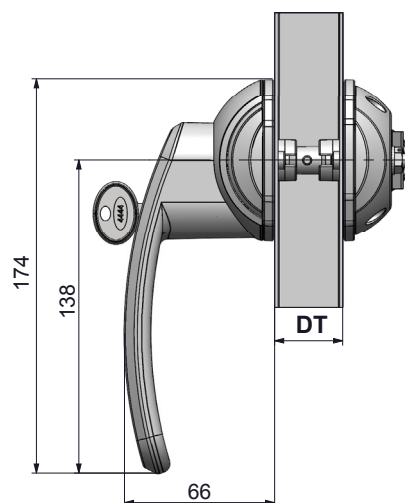
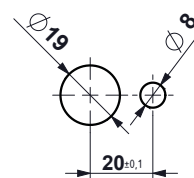

DT
30
40
50
60
70
80

Left hand  
Cut outRight hand  
Cut out

For different door thicknesses, please contact our sales team

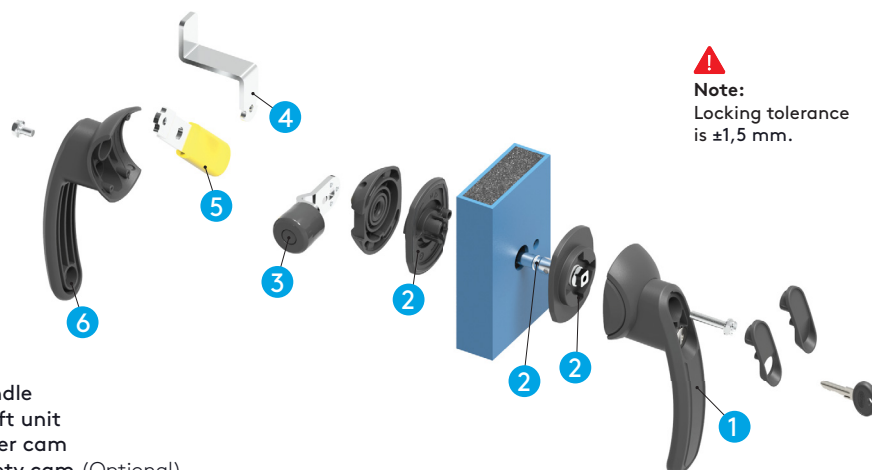

- 1: Handle  
2: Shaft unit  
3: Roller cam  
4: Safety cam (Optional)  
5: Safety interior handle (Optional)  
6: Safety interior handle (Optional)

**Note:**  
Locking tolerance  
is  $\pm 1,5$  mm.

CYLINDER TYPE	DD
Without cylinder	00
Keyed alike (Stainless steel dust cap)	03
Keyed differ (Stainless steel dust cap)	32
Euro key (5333)	05

DRIVER TYPE	DD
8 mm Square	28
10 mm Square	20
7 mm Triangular	37
8 mm Hexagon	68

PRODUCT CODE ▶

Group code	Version	Door thickness	Cylinder Driver	Cam	For only padlock
112	1	DT	DD	CC	

\*: Add "1" for padlock.

Please see

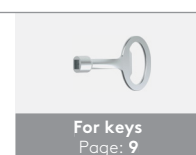
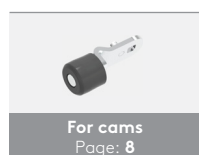

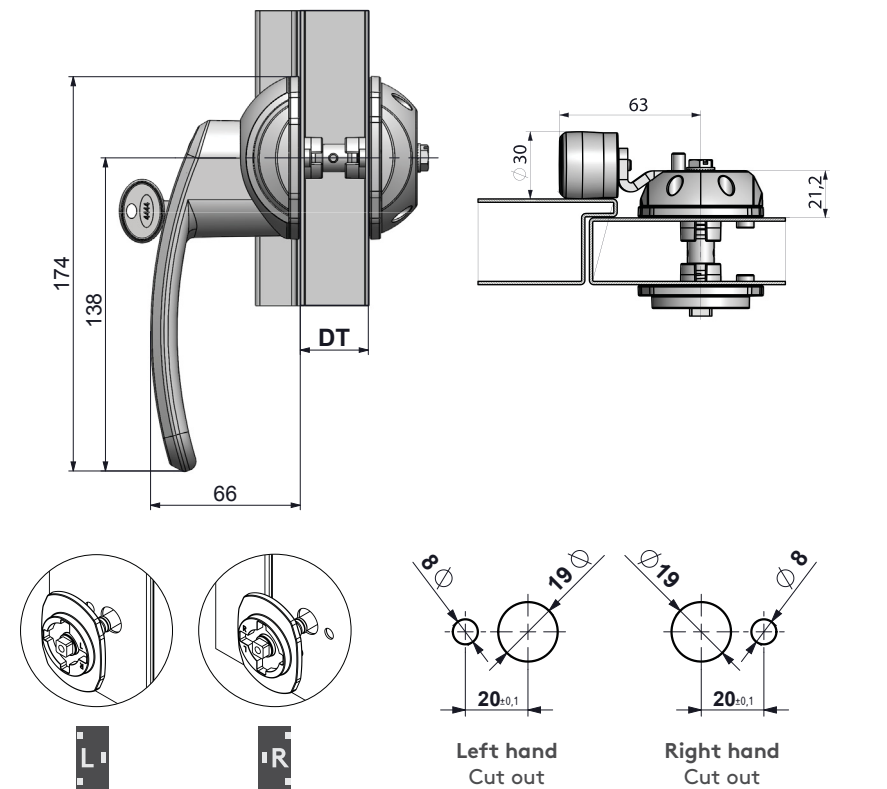

For different door thicknesses, please contact our sales team

112

IP 66

RoHS

DT
30
40
50
60
70
80

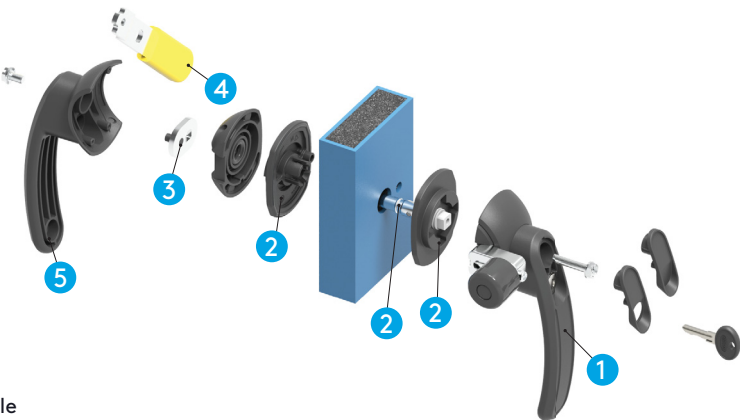

- 1: Handle  
2: Shaft unit  
3: Fixing device  
4: Safety interior handle (Optional)  
5: Safety interior handle (Optional)

Door direction	
Left hand	001
Right hand	002

CYLINDER TYPE	DD
Without cylinder	00
Keyed alike (Stainless steel dust cap)	03
Keyed differ (Stainless steel dust cap)	32
Euro key (5333)	05

DRIVER TYPE	DD
8 mm Square	28
10 mm Square	20
7 mm Triangular	37
8 mm Hexagon	68

PRODUCT CODE ▶

Group code	Version	Door thickness	Cylinder Driver	Cam	Door direction	For only padlock
112	2	DT	DD	CC		

\*: Add "1" for padlock.

Please see

Available in  
CC: 03 and 04

For cams  
Page: 8

For accessories  
Page: 8-9

For keys  
Page: 9

HVAC LOCK



- Ergonomic and stylish design
- Quick fixing
- Secure locking
- Adjustable grip length
- Suitable for inward swing doors

**MATERIAL**  
HANDLE: Polyamide DIN-EN ISO 1043-1 PA6 GFR 30  
CAM: Steel – PA6 GFR 30  
GASKET: Polyurethane

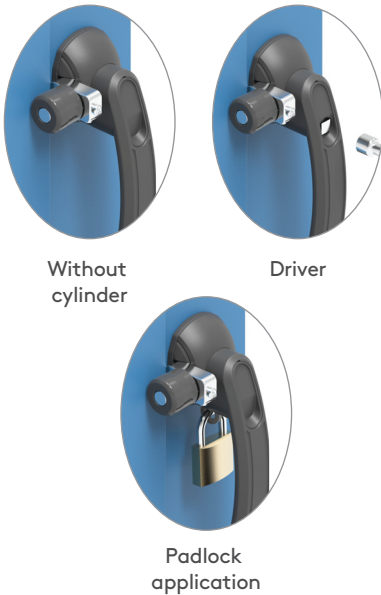

## HVAC LOCK



112

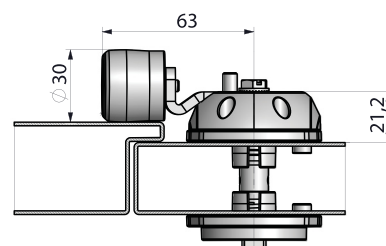
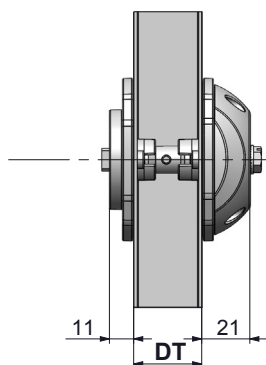
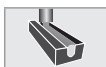

- No handle application
- Quick fixing
- Secure locking
- Adjustable grip length

### MATERIAL

CAM: Steel – PA6 GFR 30

GASKET: Polyurethane

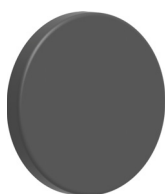

Cover

STOCK CODE

112A6

Optional

DT
30
40
50
60
70
80

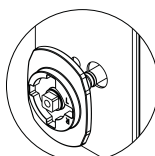

L

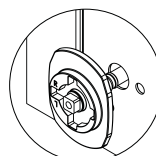

R

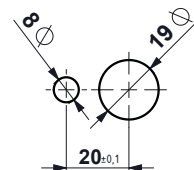

Left hand  
Cut out

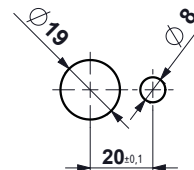

Right hand  
Cut out

For different door thicknesses, please contact our sales team

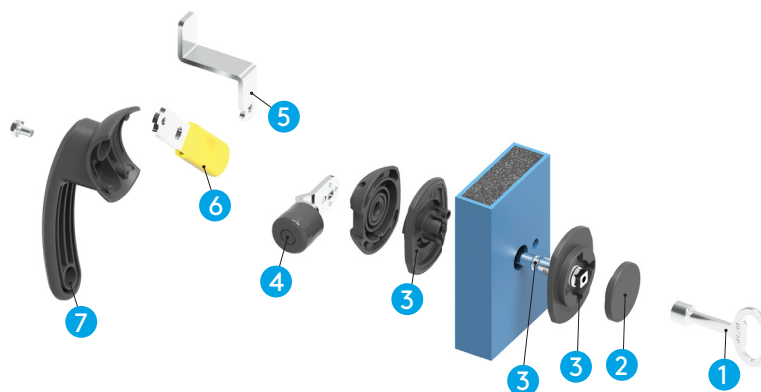

- 1: Key (36820)
- 2: Cover (Optional)
- 3: Shaft unit
- 4: Roller cam
- 5: Safety cam (Optional)
- 6: Safety interior handle (Optional)
- 7: Safety interior handle (Optional)

PRODUCT CODE ▶

Group code	Version	Door thickness	Cam	For only padlock
112	3	DT	CC	

\*: Add "1" for padlock.

Please see



For cams  
Page: 8



For accessories  
Page: 8-9



For keys  
Page: 9



HANDLES

Handle for outward opening doors

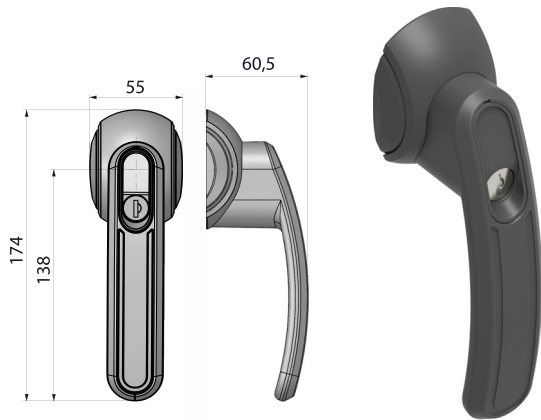

Group code	Version	Cylinder Driver	For only padlock
112H	1	DD	

\*: Add "1" for padlock.

Handle for inward opening doors

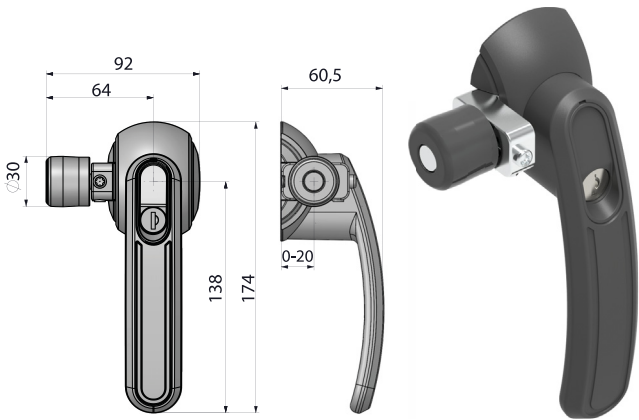

Group code	Version	Cylinder Driver	Cam	For only padlock
112H	2	DD	CC	

\*: Add "1" for padlock.



Handles can be ordered individually.  
Shaft unit is not included.

MULTIPOINT LOCKING SYSTEM

- 1 : Multiple locking unit
- 2 : Rod
- 3 : Rod adapter
- 4 : Safety interior handle

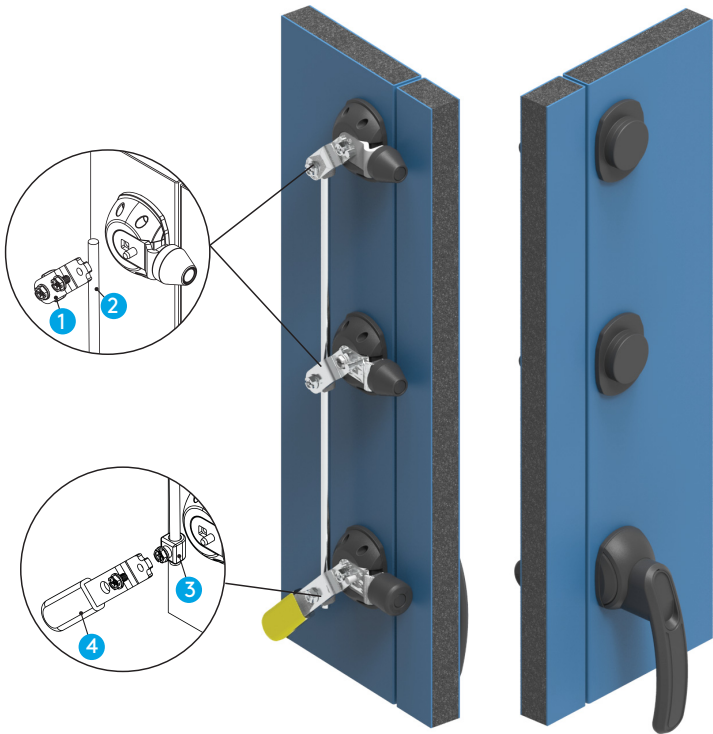

Customizable solutions in multi-point locking system by bespoke rod dimensions are upon request.  
Please contact our sales team for your technical inquiries (Sample application in image).

## CAMS



Fixed cam  
(Round roller)



Fixed cam  
(Triangle Roller)



Adjustable cam  
(Round roller)



Adjustable cam  
(Triangle Roller)

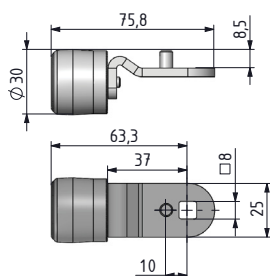

STOCK CODE	CC
112C01	01

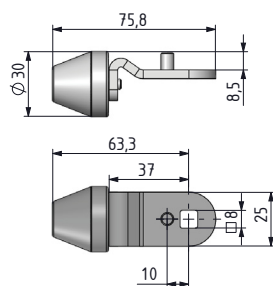

STOCK CODE	CC
112C02	02

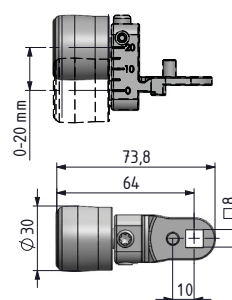

STOCK CODE	CC
112C03	03

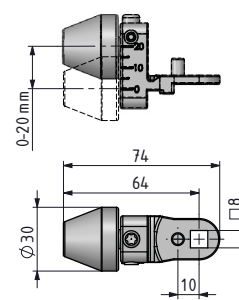

STOCK CODE	CC
112C04	04

## ACCESSORIES



Rod adapter

STOCK CODE
112A4



Multiple locking unit

STOCK CODE
112A5



Rod

Group code	Length
112IC	L



Cover

STOCK CODE
112A6

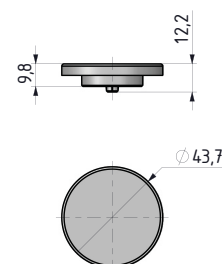
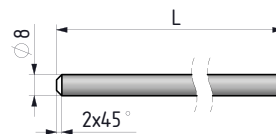
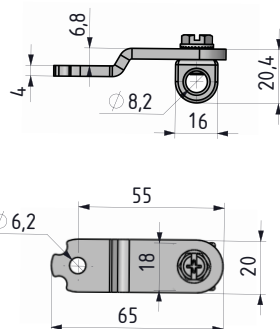
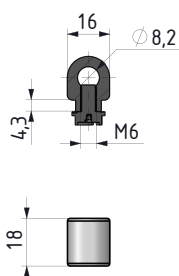



KEYS



8 mm Square

STOCK CODE
36828



10 mm Square

STOCK CODE
36820



7 mm Triangular

STOCK CODE
36837



8 mm Hexagon

STOCK CODE
36868

ACCESSORIES



Safety interior handle

STOCK CODE
112A1



Safety interior handle

STOCK CODE
112A2



Safety cam

Group code	Cam Length
112A3	CH

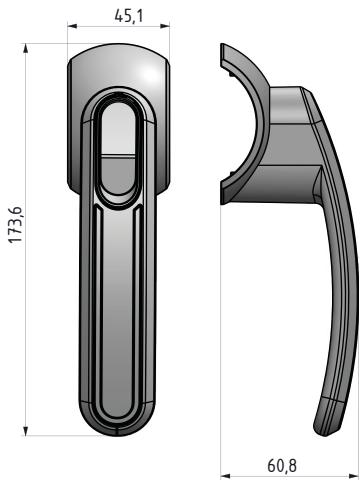
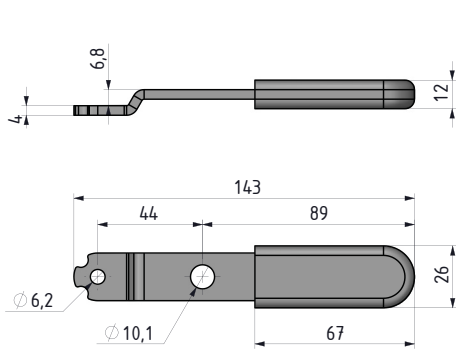

CH
25
50
75
100

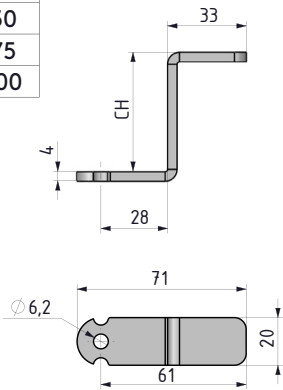

## LOCKS



### HVAC HANDLE

- Polyamide body with steel cam
- Can be used for left or right hand doors
- Roller cam allows locking by applying low force
- Removable handle allows easy on-site fitting
- Available in Eurokey (5333)
- Interior handle enables safe opening from inside



### EXTERIOR LOCKING HANDLE

- Exterior locking handle provides safety for pressurized door.



### HVAC FUNCTIONAL LOCKING HINGE

- Lock can also be used as hinge
- Door can be completely removed by simple unlocking the product



### HVAC LOCK OUTSIDE LOCKING

- Outside locking system provides safety for pressurized doors
- For logo application please contact our sales team



### ADJUSTABLE COMPRESSION LATCHES

- Chrome Plated or Black Powder Coated Die-Cast Zinc
- 6mm Compression
- Cam can be used forward or reversed
- Latch provides good compression and noise isolation



### STEPPED COVER LOCK

- For soundproof or isolated doors
- Tight closure achievable with 270° cam rotation and stepped cam



### QUARTER TURN LOCK - SPRING LOADED

- Suitable for using on thick panels
- 5mm double bit driver
- IP65 rated
- Supplied with rubber sealing gasket



## HINGES



### 3D ADJUSTABLE HVAC HINGE

- Allows three dimensional adjustments
- Height  $\pm 2\text{mm}$ , Width  $\pm 2\text{mm}$ , Depth  $\pm 2\text{mm}$
- Ideal for large flush fitting doors
- Suitable for air conditioning, electrical panels and machinery covers
- Stainless steel pin



### HVAC HINGE

- Specially designed for air conditioning central units
- Also used for plain/flush mounted heavy doors
- Hinge rotation angle 180°



### 3D ADJUSTABLE HVAC HINGE

- Hinge supplied pre-assembled to decrease labour costs
- Two-dimensional door adjustment possible
- Axial adjustment is  $\pm 2\text{ mm}$ . Radial adjustment is  $\pm 1\text{ mm}$ .



### HVAC HINGE

- Specially designed for central air conditioning units
- Stylish design
- Supplied with polyamide hinge cover and Stainless steel (AISI 304) hinge pin

## ACCESSORIES

### CIRCULAR INSPECTION WINDOW

- Visual inspection of HVAC enclosures
- Adjustable for 30-60 mm isolated doors



### CLAMPS (3D)

- Available in all die-cast zinc alloy
- 3D capability
- High mechanical resistance



### EMERGENCY STOP BUTTON

- Easy to install
- Different contact options (max. 3 contact)
- Standard wire length is 2.5 m  
Standard conduit length is 2 m



### BRIDGE CLAMPS

- Nylon with Steel screw
- Ideal for heating and ventilation panels
- Suitable for right or left hand doors



## HANDLES / GASKETS

### PULL HANDLE

- Deep grip handle
- Carrying capacity 750N / Pair
- Compact and Ergonomic design
- Installed by pushing handle into mounting hole



### COVER HANDLE

- Available for fixing with either hex bolts or cross-head screws.



### TOP BUBBLE GASKET

- Supplied in rolls of 20m
- Clip on profile offering edge protection and sealing
- Profiles are flexible and are pressed on by hand
- With steel spring core



### EPDM SPONGE ADHESIVE SEAL

- Supplied in rolls of 10m
- Easy to apply adhesive seal
- Ideal for metal enclosures

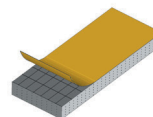



**TEL. +90 212 721 4444**  
**info@mesanlocks.com**

**MESAN KİLİT A.Ş.**  
Alipasa Sanayi Bölgesi,  
Ulugbey Sokak No: 7  
34570 Silivri İstanbul Türkiye  
Fax. +90 212 721 4445